



## Sunny Gardens Road, London, NW4 1SE

£2,200 Per Month -

Brand-new two bedroom duplex flat arranged over the ground and first floor, finished to a beautiful specification throughout. The ground floor offers a bright open-plan kitchen/living/dining space, ideal for modern living. Upstairs, the principal bedroom benefits from an en-suite, alongside a second double bedroom and a contemporary family bathroom. There is also a handy utility area and separate storage. Perfectly placed and walking distance to Sunny Hill Park.

This immaculate home is available now, offered unfurnished, with off street parking for one car and includes Super Fast WIFI.

Phone Squires Estates to arrange a viewing today, must be seen.

£2,653 Deposit

Barnet Council Tax Band - New Build Rate Not Available Yet

- Brand-new 2 Bedroom Duplex
- Beautiful, High Specification
- Bright Open-plan Kitchen/living/dining area
- Master Bedroom with En-suite
- Second double bedroom plus contemporary family bathroom
- Utility Area & Separate Storage
- Walking Distance to Sunny Hill Park
- Super Fast WIFI included
- Available Now
- Barnet Council Tax Band - New Build - Rate Not Available Yet

# Floor Plan

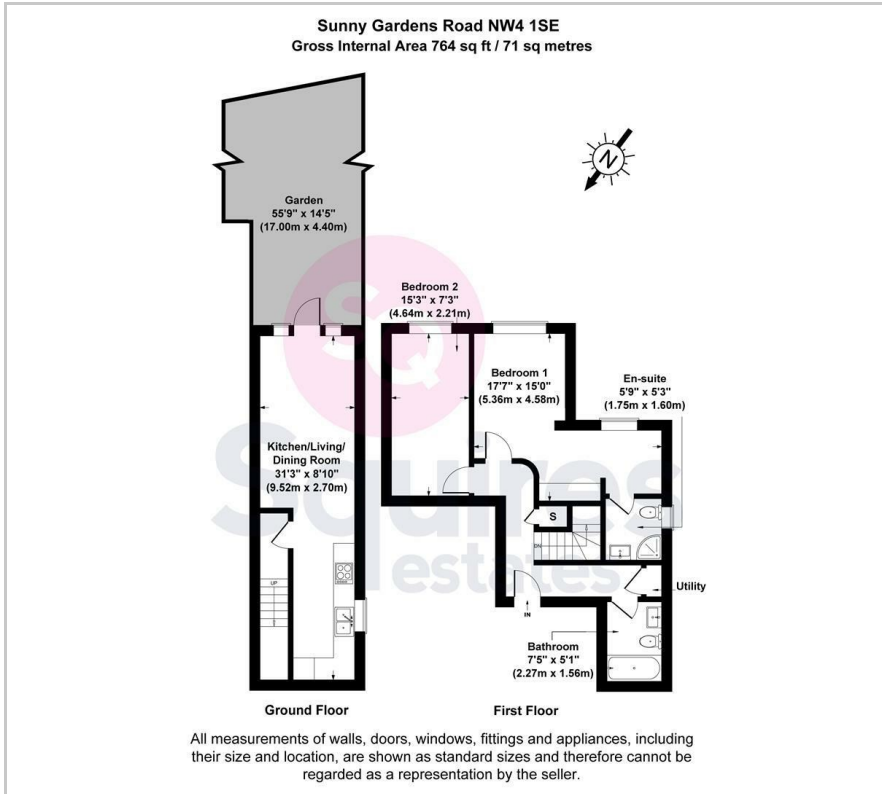

# Area Map

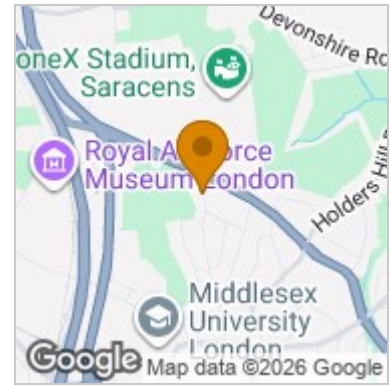

# Energy Efficiency Graph

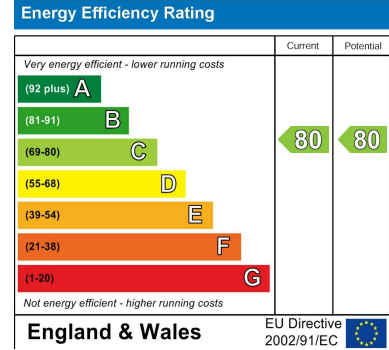

These particulars, whilst believed to be accurate are set out as a general outline only for guidance and do not constitute any part of an offer or contract. Intending purchasers should not rely on them as statements of representation of fact, but must satisfy themselves by inspection or otherwise as to their accuracy. No person in this firm's employment has the authority to make or give any representation or warranty in respect of the property.

### Finchley Branch

181a Squires Lane,  
Finchley,  
London N3 2QS  
Tel 020 8343 2111

### Hendon Branch

16 Central Circus Parade,  
Queens Road, Hendon,  
London NW4 3AS  
Tel 020 8202 0808

### Mill Hill Branch

7 Thornfield Parade,  
Holders Hill Road, Mill Hill,  
London NW7 1LN  
Tel 020 8349 3030

